

# CONVEYING POTATO CHIPS

## Conveyor 1 Design Requirements

**Product Type:** Potato Chips

**Capacity:** 4,200 Pounds per hour

**Duty:** 24/7

**Conveyor Pan Size:** 30"W x 8"D x30'6"L  
Includes (5) Eco-Slide Gates

## Conveyor 2 Design Requirements

**Product Type:** Potato Chips

**Capacity:** 4,200 Pounds per hour

**Duty:** 24/7

**Conveyor Pan Size:** 30"Wx8"Dx31'-3"L  
Includes (7) Eco-Slide Gates

### Customer Challenge

A family owned and operated snack food company who has been doing business for over 70 years, contacted Triple/S due to issues they were having with gates on their existing equipment. The gates were vibrating, loose, noisy and difficult to clean. They were looking to replace their existing equipment gates with Triple/S gates.

### Triple/S Solution

Triple/S does not retrofit gates to competitor equipment, but Triple/S Dynamics was able to provide a solution for replacement conveyors. After reviewing the current layout and ongoing issues with their current gates Triple/S Dynamics recommended two Slipstick Horizontal Motion Conveyors with Eco-Slide gates. Although this customer did not make an immediate decision to replace their current conveyors they contacted us later with the same issues with the gates, vibrating, loose, noisy and difficult to clean and were now experiencing additional issues with stress cracks in the conveyors and were unhappy with their existing equipment.

Advantages the Slipstick Horizontal Motion Conveyors will provide this customer are all stainless steel sanitary washdown construction, no product breakage, simple one-piece seamless conveyor pan for ease of cleaning, long conveyor pan lengths to minimize the number of drives required, long life, low maintenance drive assembly will provide low cost of ownership over the life of the conveyor, pan has multiple discharge gates for first-in/first-out product distribution to belt storage unit, and Eco-Slide gates equipped with TIVAR H.O.T. UHMW gate plates to accommodate hot water cleaning.

# CONVEYING POTATO CHIPS

## Conveyor 1 Design Requirements

**Product Type:** Potato Chips

**Capacity:** 4,200 Pounds per hour

**Duty:** 24/7

**Conveyor Pan Size:** 30"W x 8"Dx30'-6"L  
Includes (5) Eco-Slide Gates

## Conveyor 2 Design Requirements

**Product Type:** Potato Chips

**Capacity:** 4,200 Pounds per hour

**Duty:** 24/7

**Conveyor Pan Size:** 30"Wx8"Dx31'-3"L  
Includes (7) Eco-Slide Gates

### Triple/S and the Customer

*The Slipstick Horizontal Motion Conveyors will distribute product to the customers existing surge conveyors. Triple/S Dynamics also provides Slipstick Accumulators for on-line storage of many products such as fragile chips and crackers. The gentle horizontal motion of the conveyor is uniquely suited for the storage and discharge of the most fragile products.*

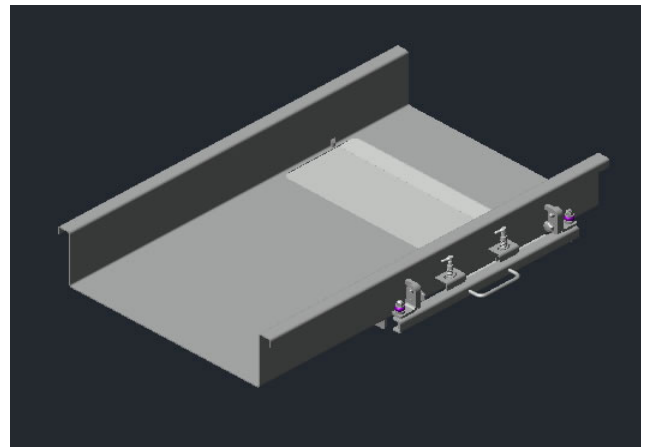
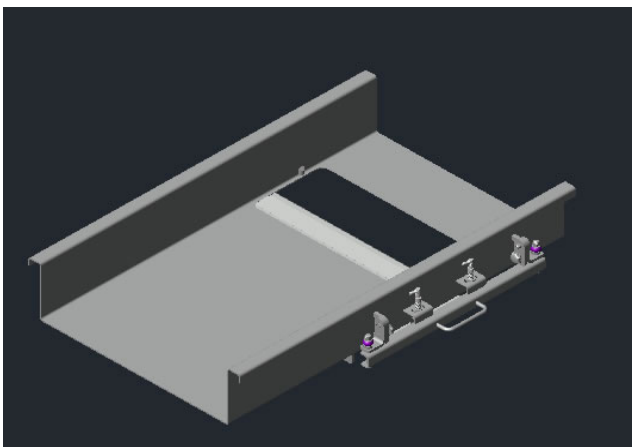

Eco-Slide Gate